

THALETEC PlusPort

Adding nozzles to glass-lined vessels in chemical and pharmaceutical plants at a later date

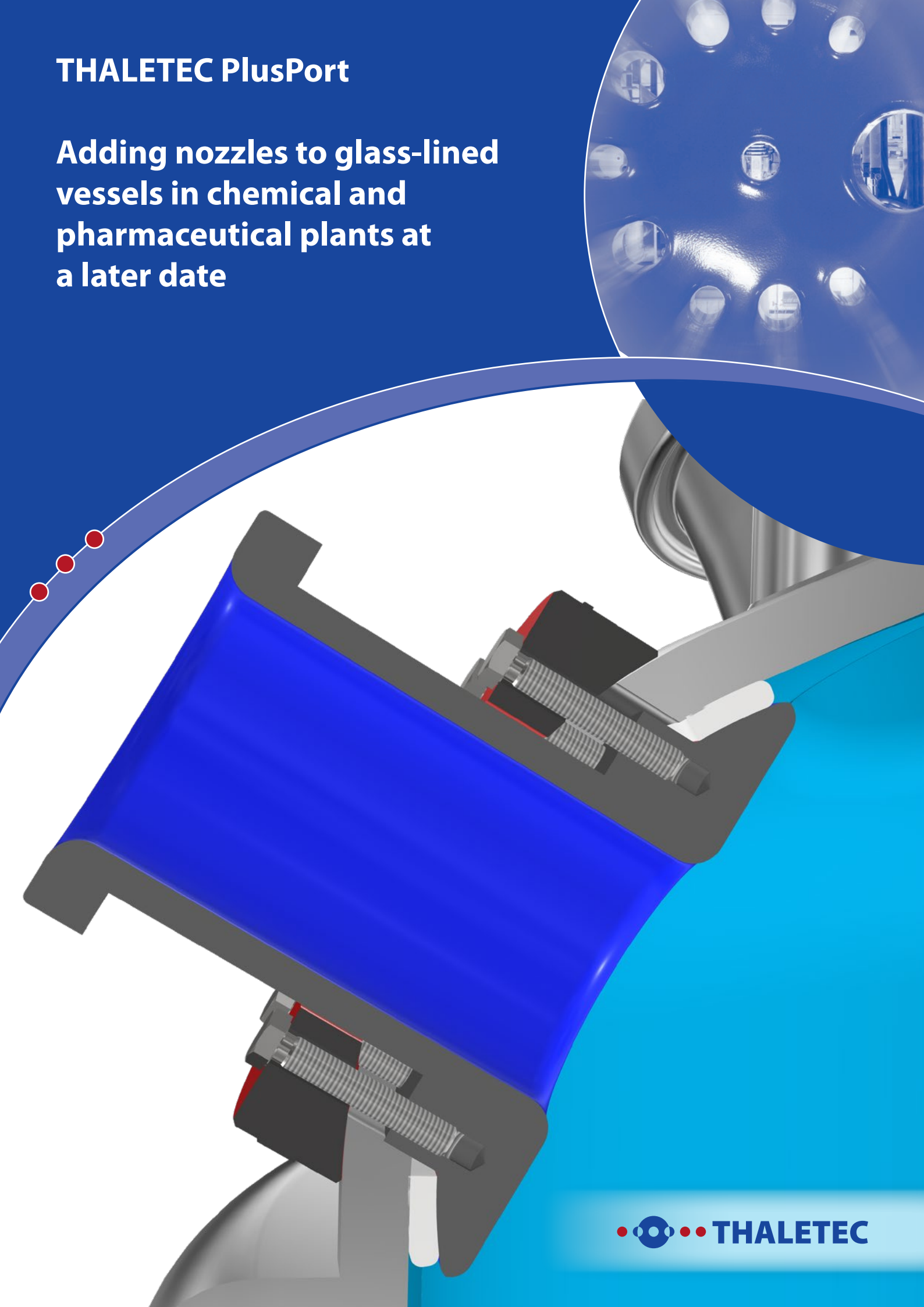

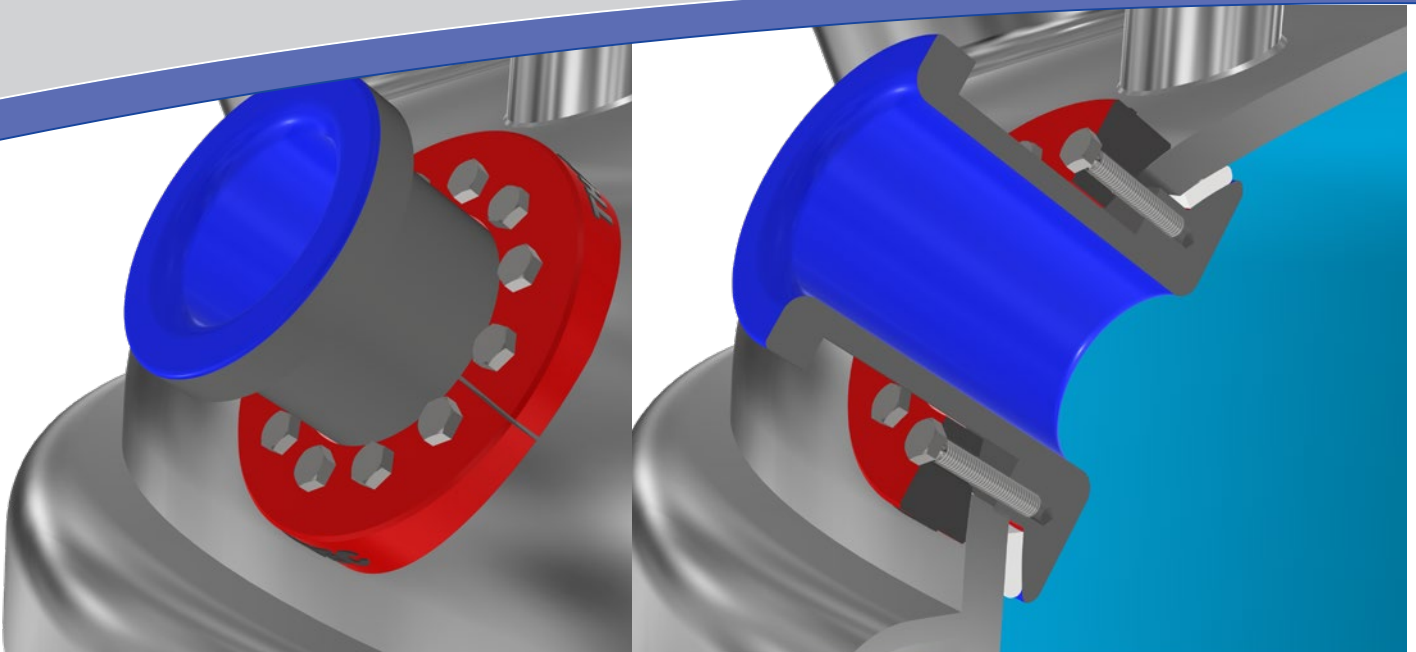

01 THALETEC PlusPort – Additional nozzle at the top head of a glass-lined vessel

Description

In order to reduce costs and drastically improve the availability of glass-lined equipment, THALETEC has developed the PlusPort concept. With this process, it is possible to provide existing glass-lined equipment of all manufacturers **with additional nozzles at almost any desired location** on site and without dismantling the equipment.

Depending on the size of the vessel and the installation location, additional nozzles can be designed up to 6". All locations are possible where the outside of the vessel is not covered by a double jacket, half pipes or other components.

Features

- Adding PlusPort nozzles to many location of an existing glass-lined vessel
- Suitable for stirred vessels, tanks, and columns of all manufacturers

- Nozzles up to DN 150 (6") possible
- Alignment of the nozzle perpendicular to the tank surface or parallel to the main tank axis
- Additional PlusPort nozzles can be glass-lined with all available glass-linings, including the electrically conductive THALETEC ConduSist (flyer K098 )

Advantages

- Installation possible in places where the outside of the vessel is not covered by a double jacket, half-pipe coils, drive parts or supporting structure elements
- Only short downtime required for measurement and installation
- No removal and installation of the vessel required; work can **be carried out on site in the plant with the vessel installed**
- Can equipment be installed in almost any position of the vessel
- Universal use of the nozzles as process connection possible

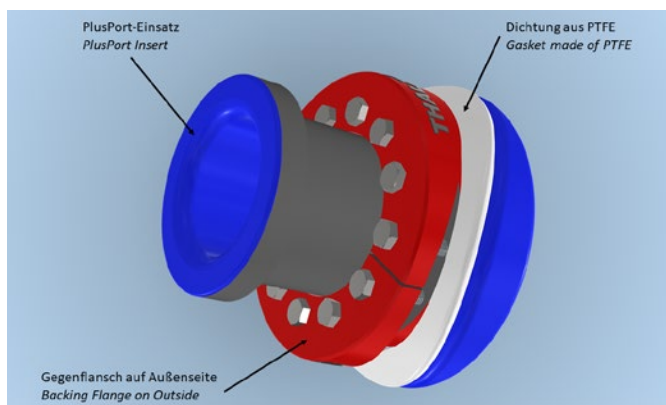

02 THALETEC PlusPort – overview of parts

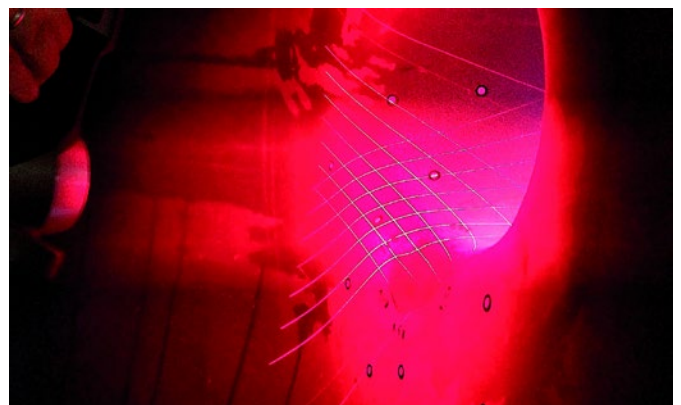

03 3D-scanning of the vessel's geometry

THALETEC GmbH

Steinbachstraße 3
D - 06502 Thale

+ 49 (0) 3947 778-0
+ 49 (0) 3947 778-130

Hotline:

+ 49 (0) 3947 778-111
service@thaletec.com
www.thaletec.com

